

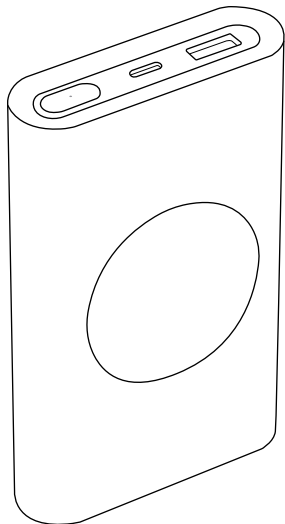

- EN** If you love your iOttie product, let us know by leaving a review online, or connect with us on our social platforms.
- FR** Si vous aimez votre produit iOttie, merci de nous le faire savoir en laissant un commentaire en ligne ou nous rejoindre sur nos réseaux sociaux.
- ES** Si le gusta su producto iOttie, háganos saber dejando una reseña en línea, o conéctese con nosotros en nuestras redes sociales.



## iON Wireless Go

10,000mAh Portable Battery Pack

**iOttie**



✉ [cs@iottie.com](mailto:cs@iottie.com) [www.iottie.com](http://www.iottie.com)

**iOttie**

# Getting Started

For optimal charge, please follow the detailed instructions in this manual when using the iON Wireless Go. iOttie is not liable for possible damages due to product misuse.

## Compatibility

- Please make sure your device is Qi Wireless compatible. Compatible devices include iPhone X, XS, XR, Samsung Galaxy S10, S10+, S10e, Note9, S9, S9+, Google Pixel 3, and any other Qi enabled devices.

<b>Input</b>	5v 2.4A ; 9v 2.0A ; 12v 1.5A
<b>Output</b>	5v 1A; 5v 2.4A ; 9v 2A ; 12v 1.5A
<b>Length</b>	116.75
<b>Width</b>	72mm
<b>Height</b>	22mm
<b>Weight</b>	7.9oz (225g)

# At a Glance:

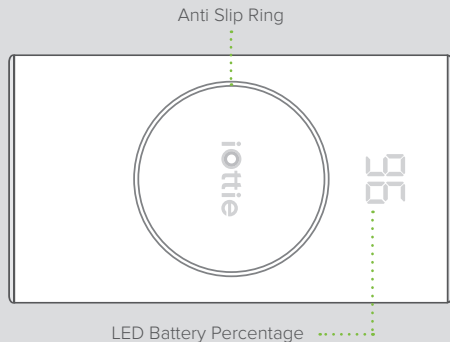
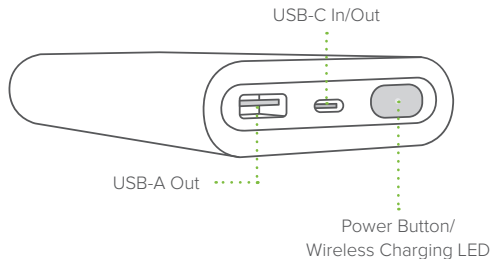

# Charging Other Devices

The iON Wireless Go allows for up to 3 devices to be charged simultaneously.

## Qi Wireless Charging

Charge your smartphone wirelessly with a standard Qi Wireless charge. The Qi Coil is usually located in the center area of the phone. Check with your phone's manufacturer for accurate Qi coil location.

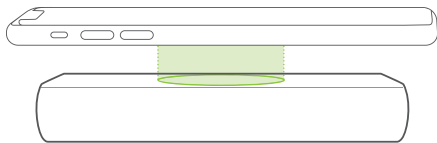

Charging surface features an anti-slip ring to prevent smartphones from shifting while charging wirelessly. This ring also marks the center of the device where the Qi coil is located.

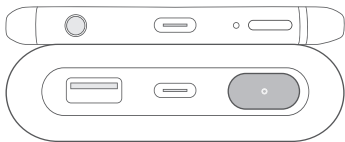

Press power button on device to initiate wireless charge. If nothing is charging, device will automatically turn off.

## Super Fast Wired Charging

USB-C and USB-A input allows simultaneous super fast charging.

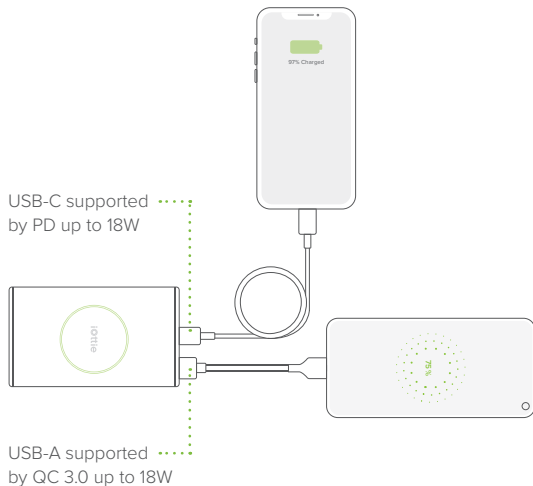

Charging speed will remain 18W per other device when plugged in (for up to 36W total for wired charging). It will go down to 5W per other device when also charging wirelessly.

## Charging the iON Wireless Go

- ! If using a third party charger, please only use a Qualcomm Quick Charge 3.0 or equivalent adapter.

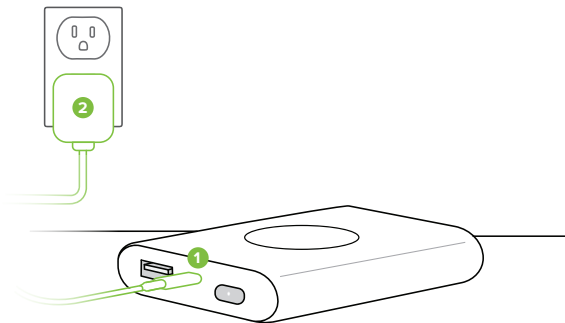

1. Plug cable into the USB-C port on device and plug other end of cable to a power adapter.
2. Plug the power adapter into an AC outlet.

- ! Charging speed for other devices will remain 18W per device while also charging the battery. It will go down to 5W when wirelessly charging another device while charging the battery.

## LED Battery Percentage

LED light on the top of the device will indicate percentage charged. If your phone is not charging, make sure the battery has a charge.

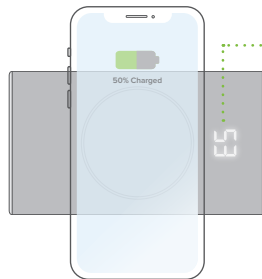

### Solid White Numbers

White light will remain on if the phone is charging or if device is plugged in.

To turn LED Battery Percentage off, press the power button for 1 second.

To turn LED Battery Percentage back on, press the power button for 1 second.



Once phone is charged, device display will automatically turn off.

# Démarrer

Pour une recharge optimales, veuillez suivre les instructions détaillées dans ce manuel lorsque vous utilisez le iON Wireless Go. iOttie n'est pas responsable des dommages éventuels causés par une mauvaise utilisation du produit.

## Compatibilité

Avant d'utiliser le produit, assurez-vous que votre appareil est compatible avec Qi Wireless. Les appareils compatibles incluent iPhone X, Xs, XR, Samsung Galaxy S10, S10+, S10e, Note9, S9, S9+, Google Pixel 3, and any other Qi enabled devices.

<b>Input</b>	5v 2.4A ; 9v 2.0A ; 12v 1.5A
<b>Output</b>	5v 1A; 5v 2.4A ; 9v 2A ; 12v 1.5A
<b>Longueur</b>	116.75mm
<b>Largeur</b>	72mm
<b>Hauteur</b>	22mm
<b>Poids</b>	7.9oz (225g)

# Aperçu

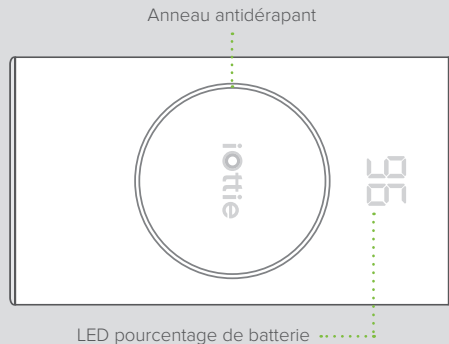
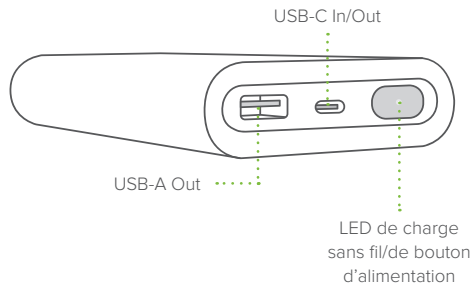

# Charge d'autres appareils

L'iON Wireless Go permet de charger jusqu'à 3 appareils simultanément.

## Charge Qi sans fil

Charge Qi sans fil : chargez sans fil votre smartphone grâce à une charge sans fil Qi standard. **La bobine Qi est généralement localisée dans la zone centrale de votre téléphone. Voyez avec le fabricant de votre téléphone pour plus de précisions concernant son emplacement.**

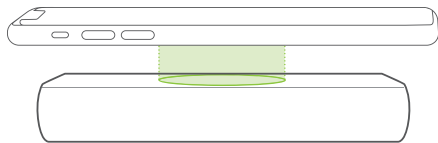

La surface de charge comprend un anneau antidérapant qui empêche les smartphones de bouger pendant leur charge sans fil. Cet anneau signale aussi le centre de l'appareil au sein duquel se trouve la bobine Qi.

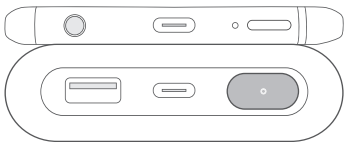

Appuyez sur le bouton d'alimentation de l'appareil pour démarrer la charge sans fil. S'il n'y a rien à charger, l'appareil s'éteindra automatiquement.

## Charge par câble super rapide

Les entrées USB-C et USB-A permettent la charge simultanée super rapide.

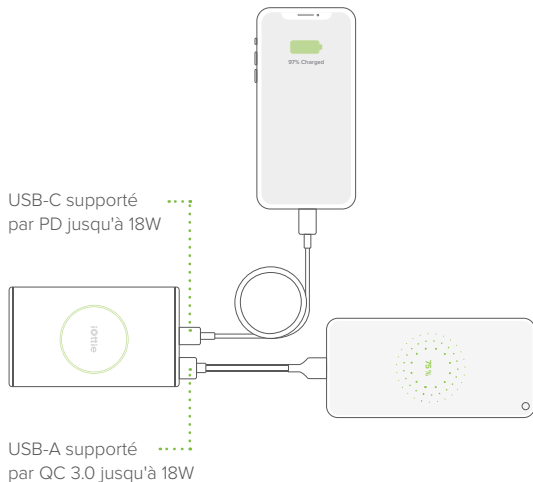

La vitesse de charge restera à 18 W par autre appareil lorsque branché (pour une somme totale maximale de 36 W lors d'une charge par câble). Cette valeur descendra à 5 W par autre appareil en cas de charge sans fil également.

## Charge de l'iON Wireless Go

- ! En cas d'utilisation d'un chargeur de tierce partie, veuillez n'utiliser qu'un adaptateur Qualcomm Quick Charge 3.0 ou équivalent.

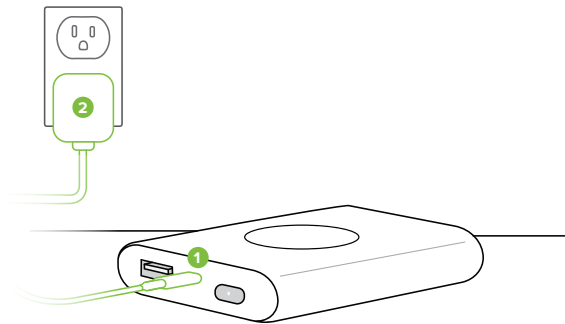

1. Branchez le câble sur le port USB-C de l'appareil puis branchez l'autre extrémité du câble à un adaptateur d'alimentation.
2. Branchez l'adaptateur d'alimentation dans une prise AC.

- ! La vitesse de charge pour les autres appareils restera à 18 W par appareil tout en chargeant aussi la batterie. Cela descendra à 5 W si, lors de la charge de la batterie, un autre appareil est chargé sans fil.

## LED pourcentage de batterie

Le voyant LED sur le haut de l'appareil indique le pourcentage de charge. Si votre téléphone n'est pas en charge, assurez-vous que la batterie a de la charge..

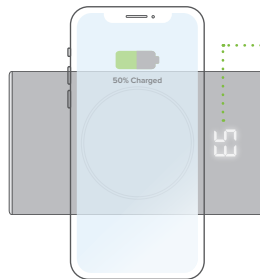

### Chiffres blancs entiers

la lumière blanche restera allumée si le téléphone est en charge ou si l'appareil est branché.

Pour éteindre la LED de pourcentage de batterie, appuyez sur le bouton d'alimentation pendant 1 seconde.



Pour rallumer la LED de pourcentage de batterie, appuyez sur le bouton d'alimentation pendant 1 seconde.

Une fois le téléphone chargé, l'affichage de l'appareil s'éteindra automatiquement.

# Declaration of Conformity (FCC)

This device complies with Part 18 of the FCC Rules.

**CAUTION:** Changes or modifications not expressly approved by the party responsible for compliance could void the user's authority to operate the product.

**NOTE:** This equipment has been tested and found to comply with the limits for a wireless power transfer, pursuant to Part 18 of the FCC Rules. These limits are designed to provide reasonable protection against harmful interference in a residential installation. This equipment generates, uses and can radiate radio frequency energy and, if not installed and used in accordance with the instructions, may cause harmful interference to radio communications. However, there is no guarantee that interference will not occur in a particular installation. If this equipment does cause harmful interference to radio or television reception, which can be determined by turning the equipment off and on, the user is encouraged to try to correct the interference by one or more of the following measures:

- Reorient or relocate the receiving antenna.
- Increase the separation between the equipment and receiver.
- Connect the equipment into an outlet on a circuit different from that to which the receiver is connected.
- Consult the dealer or an experienced radio/TV technician for help.

# Operational Warnings

- 1 During the charging process, the transfer of electricity gives off heat. Your device may become warm, but should not become exceedingly hot.
- 1 If the device gets wet, please cease charging immediately. Remove all plugs and dry the product completely. Device is only to be operated in a dry, indoor environment.
- 1 Please be careful of excessive drops, dents, punctures, or deformities on the device. If you are concerned, please unplug the device and contact the manufacturer.
- 1 Changes or modifications not expressly approved by the party responsible for compliance could void the user's authority to operate the equipment.
- 1 Operating this device in a hot environment or in direct sunlight for a long period of time may cause malfunctions. We recommend keeping the product in cooler temperatures.
- 1 Please use included components for an optimal experience. To support Qi fast charge when using a third party charger or a USB Power Adapter use a minimum output of both "9.0V-2.0A or 12V-1.5A".
- 1 If your phone is misaligned when wireless charging, your device may become warm due to inefficient wireless output. It is important to always properly align your smartphone.
- 1 California Proposition 65: This product contains chemicals known to the state of California to cause cancer and birth defects or other reproductive harm.



## Caution

Old electrical appliances must not be disposed of together with residual waste, but have to be disposed of separately.