

Easy One Touch 6

Air Vent Mount

User Manual

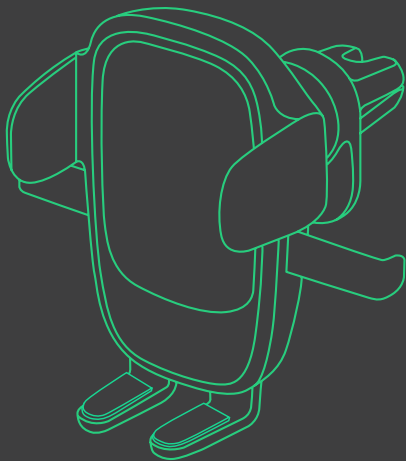

Easy One Touch 6

Air Vent Mount

User Manual

	English	04
	French	10
	Italian	16
	German	22
	Spanish	28

Index

For optimal mounting, please follow the detailed instructions within this manual when using the Easy One Touch 6. iOttie is not liable for damages due to product misuse.

- 01 Product Information**
 - At a Glance
 - Product Specifications

- 02 Installation**
 - Attaching the Mount
 - Adjusting the Mount
 - Easy One Touch Mechanism

01 Product Information

At a Glance

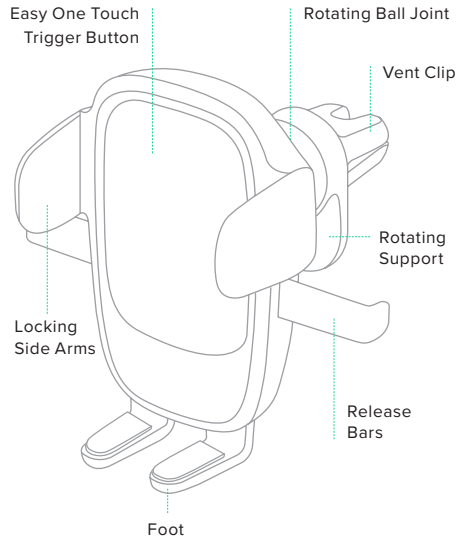
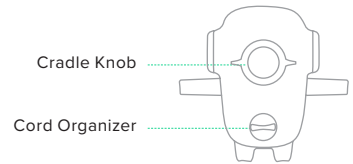

Product Specifications

Item	Specification
Length	4.02"
Width	4.26"
Height	4"
Weight	3.8 oz

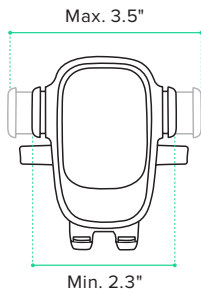

*Universal design fits all smartphone and case combinations.

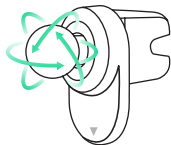

*Mount rotates 360° for optimal viewing angles.

02 Installation

Attaching the Mount

1. Connect the cradle to the vent mount and tighten the cradle knob.

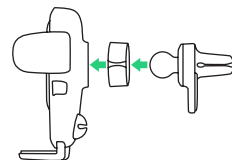

2. Push the mount all the way onto the air vent blades.

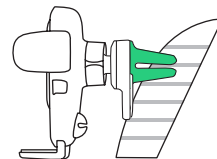

3. Adjust the rotating support so it is facing down.

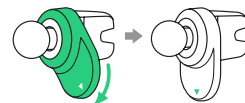

Adjusting the Mount

Cradle Knob

To rotate the cradle, loosen the cradle knob. Tighten to lock into desired position.

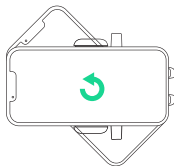
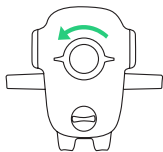

Bottom Foot

To adjust the bottom foot, pull it down or push it up. There are 5 height settings.

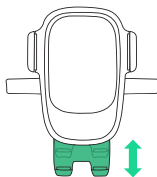

Easy One Touch Mechanism

The Easy One Touch lock and release mechanism makes it simply to mount and retrieve your smartphone in seconds.

[Mounting]

1. Squeeze the release bars.

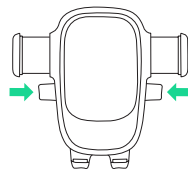

2. Press your device against the Easy One Touch trigger button. The mount's arms will automatically close on contact.

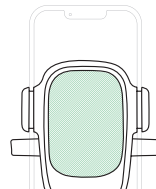

[Releasing]

Squeeze the release bars again to release your device.

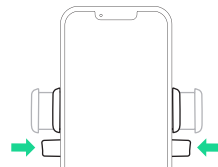

Indice

Pour un montage optimal, veuillez suivre les instructions détaillées de ce manuel lorsque vous utilisez l'Easy One Touch 6. iOttie n'est pas responsable des dommages éventuels causés par une mauvaise utilisation du produit.

01 Informations du produit

Aperçu

Caractéristiques du produit

02 Installation

Fixation du support

Ajustement de l'assemblage

Mécanisme Easy One Touch

01 Informations sur le produit

Aperçu

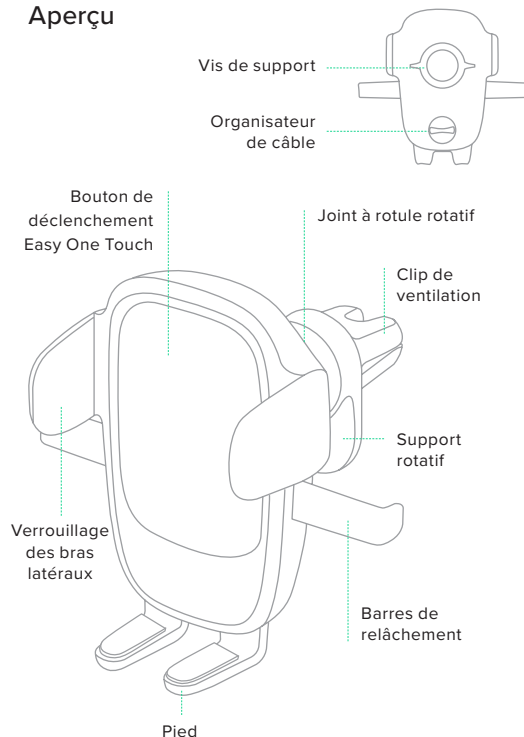

Caractéristiques du produit

Article	Caractéristique
Longueur	10.21 cm
Largeur	10.83 cm
Hauteur	10.16 cm
Poids	107.73 g

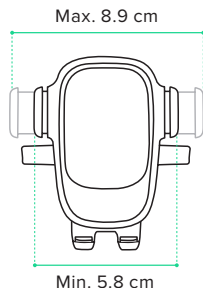

*La conception universelle s'adapte à toutes les combinaisons de smartphones et d'étuis.

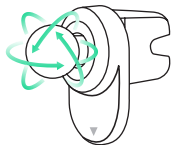

02 Installation

Fixation du support

1. Connectez le berceau au support de ventilation et serrez le bouton du berceau.

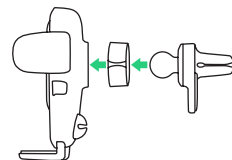

2. Poussez complètement le support sur les lames d'aération.

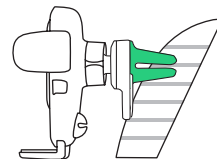

3. Ajustez le support rotatif de sorte qu'il soit orienté vers le bas.

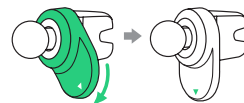

Ajustement de l'assemblage

Vis de support

Pour faire pivoter le support, desserrez la vis de support. Serrez pour verrouiller dans la position désirée.

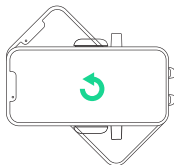
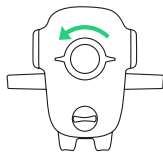

Bas du pied

Pour régler le pied inférieur, tirez-le vers le bas ou poussez-le vers le haut. Il y a 5 réglages de hauteur.

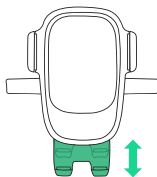

Mécanisme Easy One Touch

Le mécanisme de verrouillage et de dégageur Easy One Touch facilite le montage et le retrait rapide des smartphones.

[Montage]

1. Appuyez sur les bras de relâchement latéraux.
2. Appuyez votre appareil contre le bouton d'enclenchement Easy One Touch. Les bras de montage se ferment automatiquement au contact et maintiendront l'appareil au cours de la conduite.

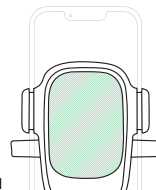
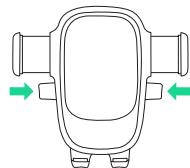

[Libération]

Appuyez sur les bras de relâchement latéraux avec une main et récupérez l'appareil.

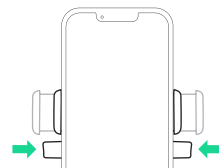

Indice

Per un montaggio ottimale, si prega di seguire le istruzioni dettagliate all'interno di questo manuale quando si usa il Easy One Touch 6. iOttie non è responsabile per eventuali danni causati da un uso improprio del prodotto.

01 Informazioni del prodotto

Sommario

Specifiche del prodotto

02 Installation

Collegare il supporto

Regolazione del supporto

Meccanismo Easy One Touch

01 Informazioni del prodotto

Sommario

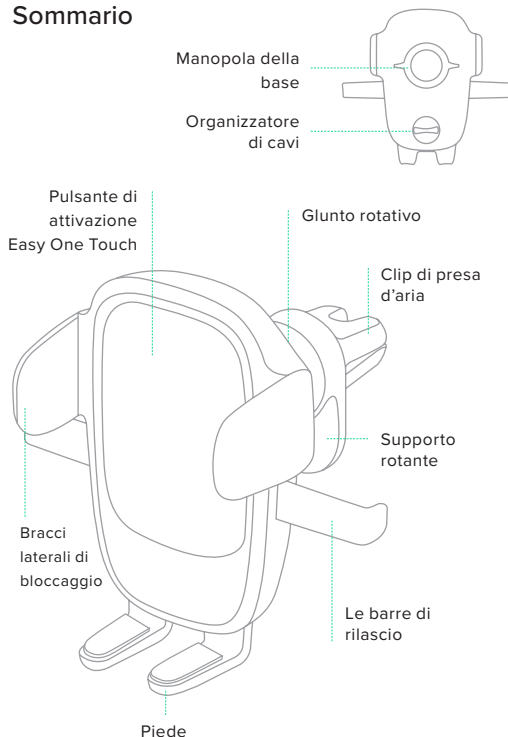

Specifiche del prodotto

Descrizione	Specifiche
Lunghezza	10.21 cm
Larghezza	10.83 cm
Altezza	10.16 cm
Peso	107.73 g

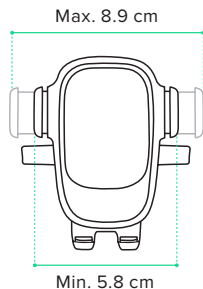

*Il design universale si adatta a tutte le combinazioni di smartphone e custodia.

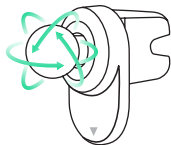

02 Installation

Collegare il supporto

1. Collegare la base al supporto della presa d'aria e serrare la manopola della base.

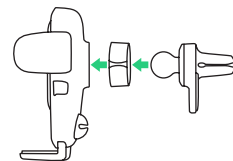

2. Spingere il supporto fino in fondo sulle lame della presa d'aria.

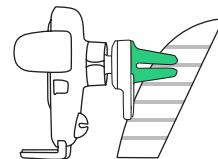

3. Regolare il supporto rotante in modo che sia rivolto verso il basso.

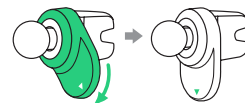

Regolazione del supporto

Manopola della base

Per ruotare la base, allentare la manopola della base. Serrare per bloccare nella posizione desiderata.

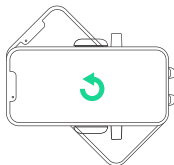
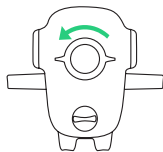

Piede inferiore

Per regolare il piedino inferiore, tiralo verso il basso o spingilo verso l'alto. Ci sono 5 impostazioni di altezza.

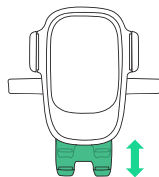

Meccanismo Easy One Touch

Il meccanismo di blocco e rilascio Easy One Touch semplifica il montaggio e il recupero del tuo smartphone in pochi secondi.

[Il montaggio]

1. Premere i bracci laterali di rilascio.

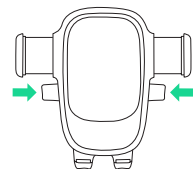

2. Premere il dispositivo contro il pulsante di attivazione Easy One Touch. I bracci del supporto chiuderanno automaticamente al contatto e terranno il dispositivo durante il viaggio.

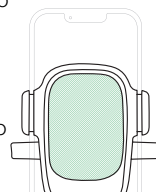

[Il rilascio]

Premere i bracci laterali di rilascio con una mano e recuperare il dispositivo.

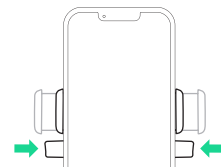

Index

Befolgen Sie für einen optimalen Einbau die detaillierten Anweisungen in diesem Handbuch, wenn Sie das Easy One Touch 6 verwenden. iOttie haftet nicht für mögliche Schäden, die auf Grund einer unsachgemäßen Verwendung des Produkts entstehen.

01 Produktinformationen

Auf einen Blick
Produktspezifikationen

02 Installation

Befestigung der Halterung
Einstellung der Halterung
Easy-One-Touch Mechanismus

01 Produktinformationen

Auf einen Blick

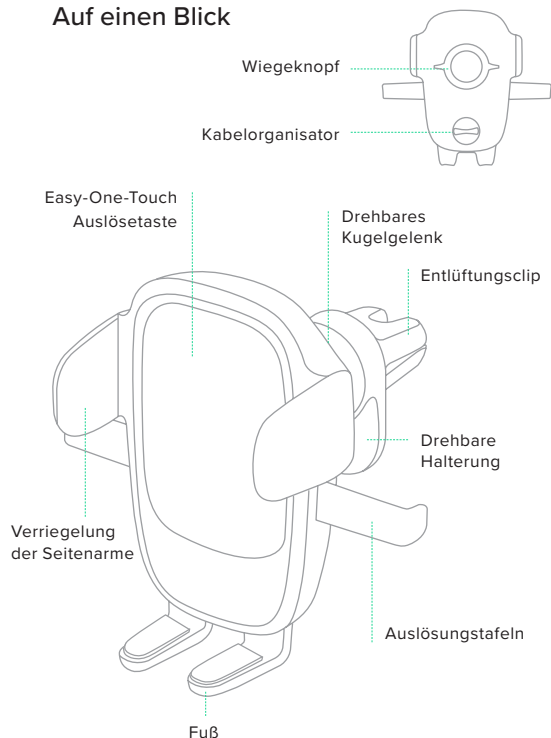

Produktspezifikationen

Daten	Spezifikation
Länge	10.21 cm
Breite	10.83 cm
Höhe	10.16 cm
Gewicht	107.73 g

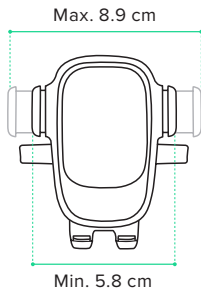

*Das universelle Design passt zu allen Smartphone- und Hüllen Kombinationen.

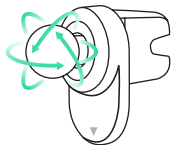

*Halterung um 360° drehbar für optimale Betrachtungswinkel.

02 Installation

Befestigung der Halterung

1. Verbinden Sie die Halterung mit der Lüftungshalterung und ziehen Sie den Halterungsknopf an.

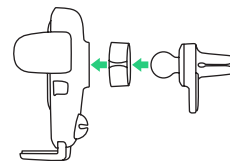

2. Schieben Sie die Halterung ganz auf die Luftausströmer Lamellen.

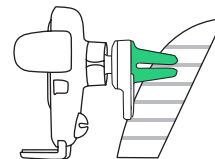

3. Stellen Sie die drehbare Halterung so ein, dass sie nach unten zeigt.

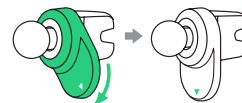

Einstellung der Halterung

Wiegeknopf

Um die Wiege zu drehen, lösen Sie den Wiesenknopf. Anziehen, um in der gewünschten Position zu arretieren.

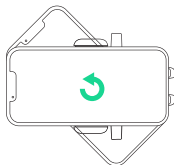
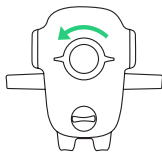

Unterer Fuß

Um den unteren Fuß einzustellen, ziehen Sie ihn nach unten oder schieben Sie ihn nach oben. Es gibt 5 Höheneinstellungen.

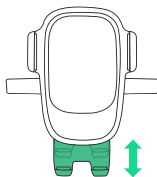

Easy-One-Touch-Mechanismus

Mit dem Easy-One-Touch-Verriegelungs- und Freigabemechanismus können Sie Ihr Smartphone in Sekundenschnelle montieren und abholen.

[Einbau]

1. Drücken Sie die Auslösungstaste ein.

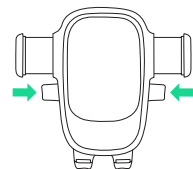

2. Drücken Sie Ihr Gerät gegen die Easy-One-Touch-Auslösetaste. Die Arme der Halterung schließen sich bei Berührung automatisch und halten das Gerät während der Fahrt.

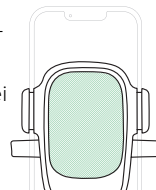

[Freigabe]

Drücken Sie die Auslösungstaste mit einer Hand und holen Sie das Gerät ab.

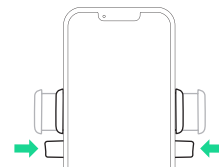

Índice

Para conseguir una fijación ideal, siga atentamente las instrucciones que se incluyen en este manual al usar el Easy One Touch 6. iOttie no es responsable por posibles daños debidos al uso incorrecto del producto.

01 Información del producto

A simple vista

Especificaciones del producto

02 Instalación

Instalando el soporte

Ajuste del soporte

Mecanismo Easy One Touch

01 Información del producto

A simple vista

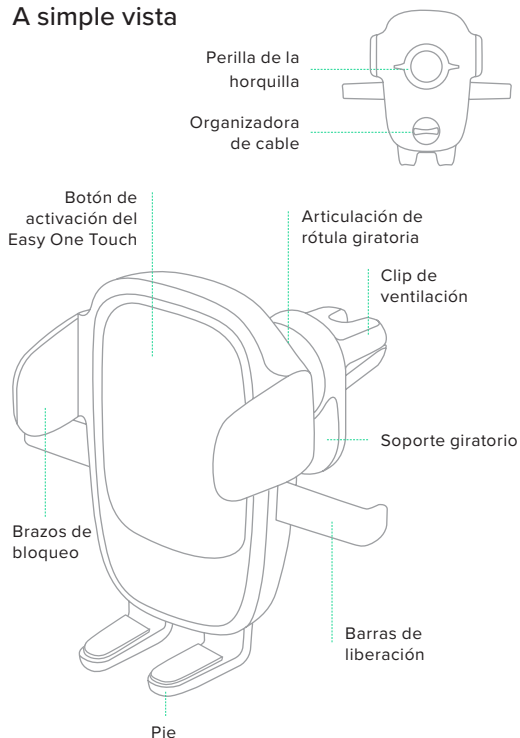

Especificaciones del producto

Elemento	Especificación
Longitud	10.21 cm
Ancho	10.83 cm
Altura	10.16 cm
Peso	107.73 g

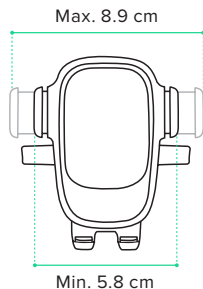

*El diseño universal se adapta a todas las combinaciones de teléfonos inteligentes y estuches.

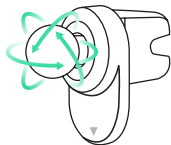

*La montura gira 360° para obtener ángulos de visión óptimos.

02 Instalación

Instalando el soporte

1. Conecte la base al soporte de ventilación y apriete la perilla de la base.

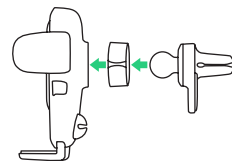

2. Empuje el soporte hasta el final sobre las aspas de ventilación de aire.

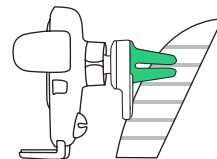

3. Ajuste el soporte giratorio que el quede hacia abajo.

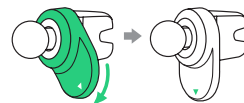

Ajuste del soporte

Manopola della base

Para girar la horquilla, afloja la perilla de la horquilla. Apriete para bloquear en la posición deseada.

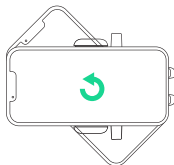
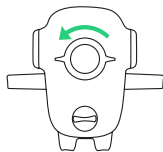

Pie inferior

Para ajustar el pie inferior, tire de él hacia abajo o empujelo hacia arriba. Hay 5 ajustes de altura.

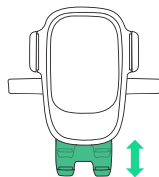

Mecanismo Easy One Touch

El mecanismo de bloqueo y desenganche Easy One Touch hace que sea fácil colocar y retirar teléfonos inteligentes en cuestión de segundos.

[Colocación]

1. Presione las barras de liberación.

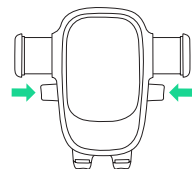

2. Presione su dispositivo contra el botón de activación del Easy One Touch.

Los brazos de la montura se cerrarán automáticamente al entrar en contacto y sujetarán el dispositivo durante el viaje.

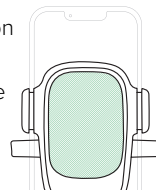

[Retirar]

Presione las barras de liberación con una mano y retire el dispositivo.

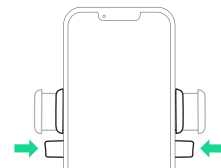



The Easy One Touch 6 Air Vent Mount is backed by a 2 year warranty.

iottie